

# LIFTER SERIES



NIPPON CAREER  
LIFTER  
CATALOG

## L-25B Specifications

Model	L-25B-A/B/C
Useable containers(standard)	W-201 (200L)
Loading capacity	240kg (gross)
Drive	3phase 200V 1.5kW (with brake)
Lifting speed	3.6/4.3m/min (50/60Hz)
Ejection angle	45°

### L-25B Lifting Height/Machine Weight Table

Item	Dimensional drawing H1(mm)	Dimensional drawing H2(mm)	Dimensional drawing H3(mm)	Machine weight kg
Lifting height specs	1~9			
A	2426	1760~1360	1683~1283	390
B	2826	2160~1760	2083~1683	420
C	3226	2560~2160	2483~2083	450

[Dimensions]  
L-25B

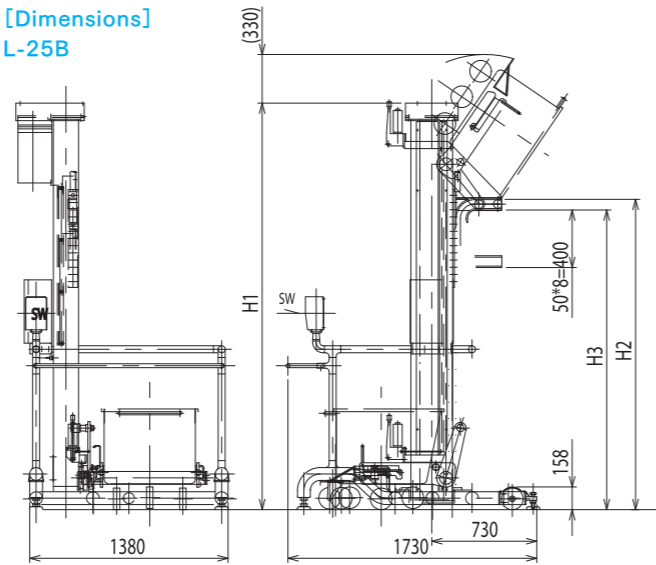

## L-64 Specifications

Model	L-64-A/B
Useable containers(standard)	W-061 (60L)
Loading capacity	60kg (gross)
Drive	3phase 200V 0.75kW (with brake)
Lifting speed	4.7/5.7m/min (50/60Hz)
Ejection angle	54°

### L-64 Lifting Height/Machine Weight Table

Item	Dimensional drawing H1(mm)	Dimensional drawing H2(mm)	Machine weight kg
Lifting height specs	1~9		
A	2460	1880~1480	220
B	2860	2280~1880	230

[Dimensions]  
L-64

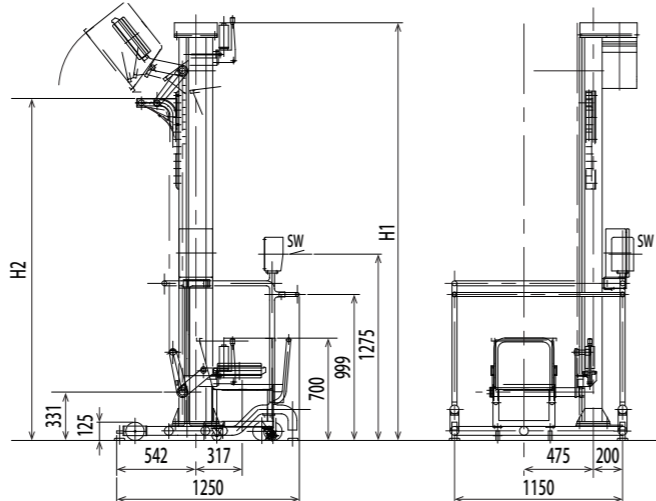

Agent:



Challenging "Perfection"  
**NIPPON CAREER INDUSTRY CO., LTD.**

980-5 Higashi habu-machi, Matsuyama City, Ehime, Japan. 7918043  
TEL: +81-89-908-7373  
E-mail: eigyou-oversea@nippon-career.co.jp  
<https://www.nippon-career.co.jp>



L-25B

**LIFTER**  
L-25B / L-64



# Safety First Design, Ease of Maintenance

Dedicated wagon lifter reduces labor involved in meat processing.

Nippon Career also offers a wide variety of variations such as lifters for commercial containers and lifters equipped with purpose-built buckets.

## Lifter Lineup

### Wagon Lifter L-25B/Liftman L-64

Stable, safety prioritizing screw design. Also offers superior durability with special thickness nut. Brake equipped motor ensures accurate stop positioning.

- Motor is installed parallel to screw shaft, enabling decreased machine height (compared with conventional models -330 mm).
- Lifting height can be set to 50mm pitch for 9 levels and easily changed.
- Equipped with screw lubrication system. Nut is lubricated via a cartridge style auto greaser (grease pump), enabling easy refilling.
- The grease used is for food manufacturing machines (H1 grade).
- Equipped with reverse phase detector to prevent reverse rotation problems during operation.
- Maintains position and does not descend when stopped during lifting.

### Wagon Lifter L-25B

Max load 240kg



#### Improved hygienity

Rounded pipe design used around legs is easy to clean.



### Liftman L-64

Max load 60kg



#### Diverse range of Wagon lifter L-25B - 12 types

※Liftman L-64 - 4 types

[Mounting]

- [M] : Operation panel on left with wheel
- [MR] : Operation panel on right with wheel

[Mounting]



- [F] : Operation panel on left without wheel
- [FR] : Operation panel on right without wheel
- [M] : Operation panel on left with wheel
- [MR] : Operation panel on right with wheel
- [S] : Operation panel on left floor secured
- [SR] : Operation panel on right floor secured

[Height]



- [A] : 2,426mm
- [B] : 2,826mm
- [C] : 3,226mm

[Lifter height adjustment]



1 ~ 9 levels

## Features

- Safety lock nut engages even if nut wears out, preventing wagon from falling.
- Equipped with wagon position sensor.
- Equipped with emergency stop button.
- Equipped with low voltage control circuit.
- Equipped with lockout switch.



Operation panel



Low voltage control circuit



Wagon position sensor

Grease pump

### Safety lock nut [during operation]

In the event the nut wears out and loses its threads, the tapered bottom of the nut comes in contact with the safety lock, causing the nut to grip the screw shaft and lock in place, thus preventing the wagon from falling.

※During normal operation, the safety lock nut mechanism rotates freely, preventing abrasion of the system.

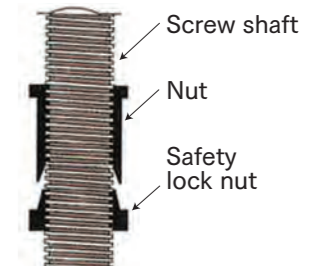

Screw shaft

Nut

Safety lock nut

## Custom specification

We also support custom-made specifications that correspond to raw materials, machine shape of input destination, and customer's own safety standards.



Safety guard remodeling



Liquid specification



With auxiliary hopper